

Sky-watcher Product Description

Handle-and-Wheel Assembly for large DOBs

The Dobsonians are increasing and getting larger and heavier, which are difficult for users to transport and observe. To help users enjoy their observations and transport the Dobsonians to an appropriate observing place easily, we've specially designed a handle-and-wheel assembly for the Dobsonians.

This handle-and-wheel assembly is easy to carry and assemble. It is very convenient and universal. It doesn't need to do any modifications on the current Dobsonians. With three 10" wheels, it can move on some complicated terrains (like on lawn). Users don't need to take off the Dobsonian from the handle-and-wheel assembly during transportation or using. It is a pretty good subsidiary product to Dobsonians.

There are two models, one is suitable for DOB14 and DOB16, the other is suitable for DOB8, DOB10 and DOB12.

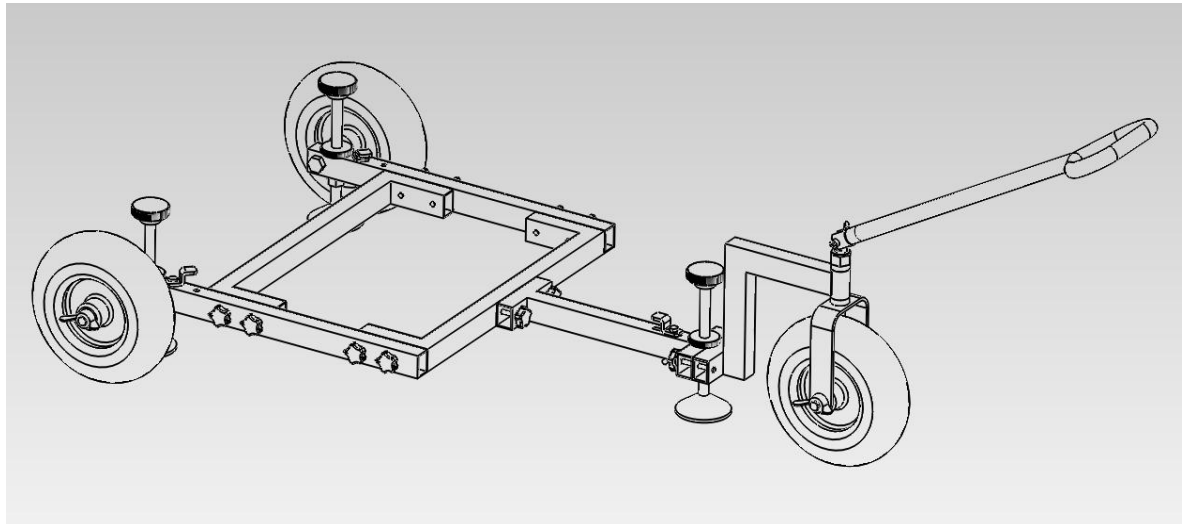

The handle-and-wheel assembly concept drawing

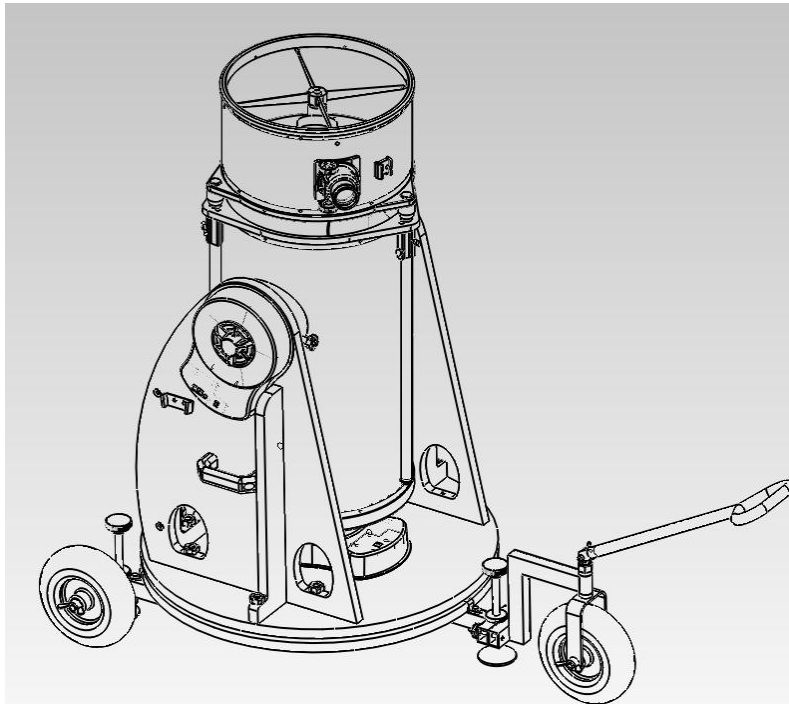

With a DOB16

A. Easy to carry and assemble

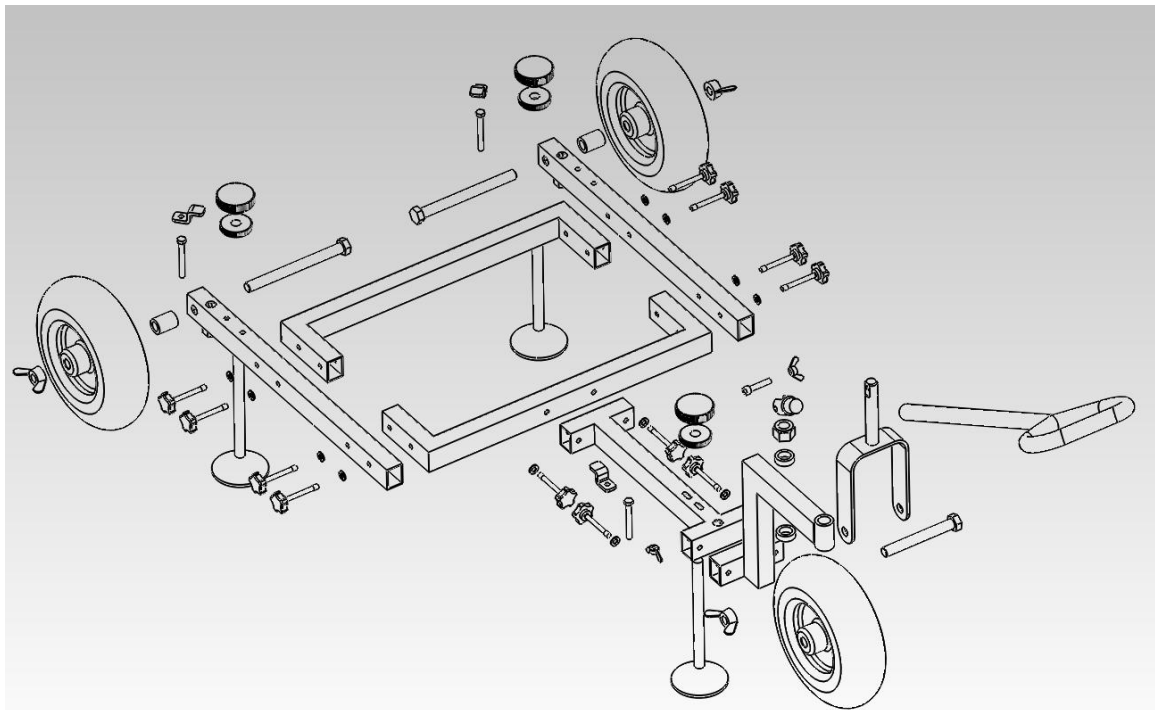

The Explosion Drawing

All the parts of the handle-and-wheel assembly can be disassembled, which is very convenient for packing and transportation and don't need too much room. It is also very easy to assemble according to the instruction. And most parts are standard ones, very easy to replace if missed or broken.

B. Transport and assemble

Put the Dobsonian bases onto the handle-and-wheel assembly and lock the ground plate with three hooks (as shown in picture 1 below), then fix them together with three thumb nuts.

There are three 10" wheels on this assembly, the two rear wheels can only be moved back and forth but the front wheel can be moved in any directions under the drive by the pull bar. So in transportation, users just need to pull the pull bar to move the handle-and-wheel assembly to any places they want to go.

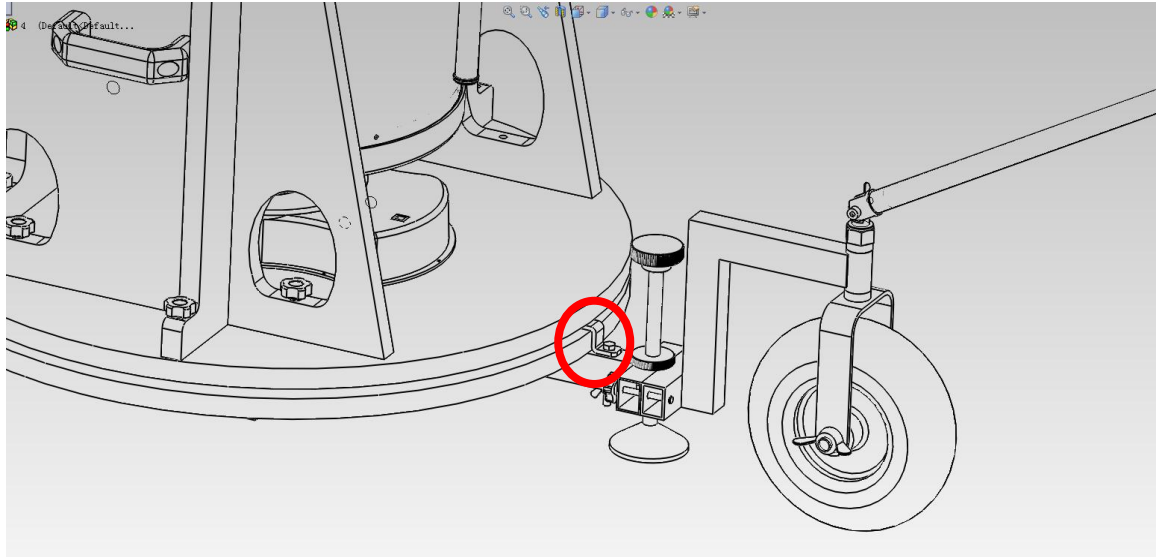

Picture 1

C, Observation

After arriving at the ideal observing place, users don't need to take off their Dobsonians. They can rotate the three adjustable knobs to let the three feet attach to the ground and level it, then lock the knobs (as shown in picture 2 below). Now, users can disassemble the three wheels (as shown in picture 3 below). Loosen the two thumb nuts on the two sides of the wheels and take off the two rear wheels. It is also very easy to take off the front wheel, loosen the two knobs in the picture and then take off the wheel together with the holder. After observing, re-assemble the wheels and rise up the three feet to let the wheels attach to the ground, now users can take their Dobsonian away.

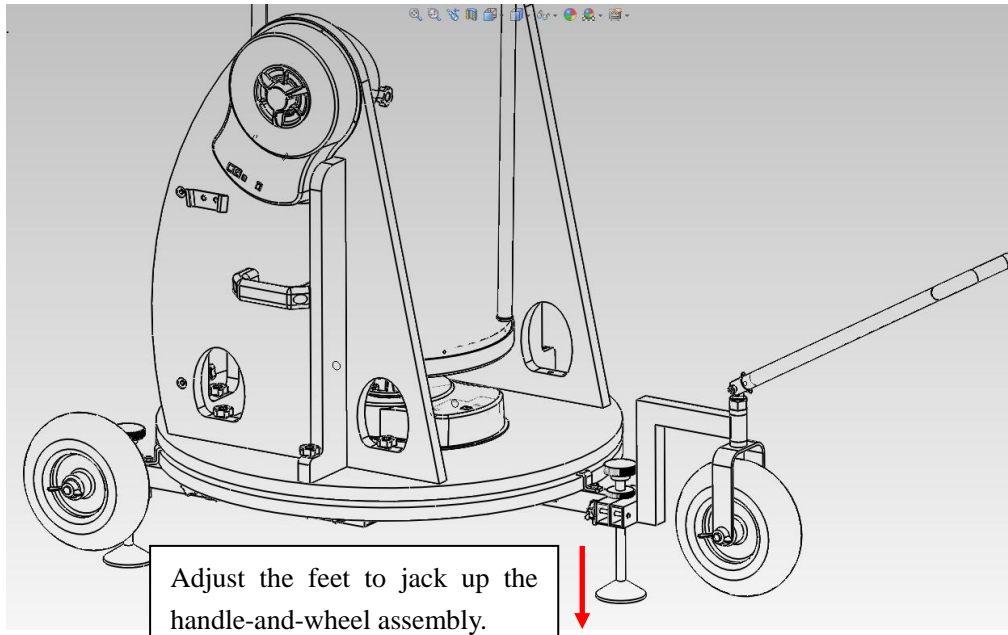

Picture 2

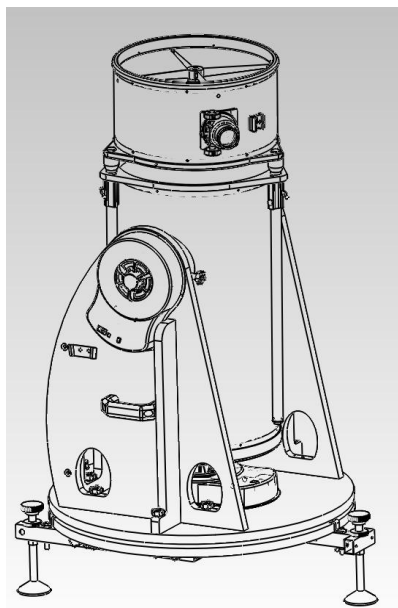

Picture 3 (The status after taking off the wheels)